

How to place an order for AT&T Wireless Broadband through Premier

if you are an existing AT&T customer.

1 Using your existing username and password, [log into Premier](#).

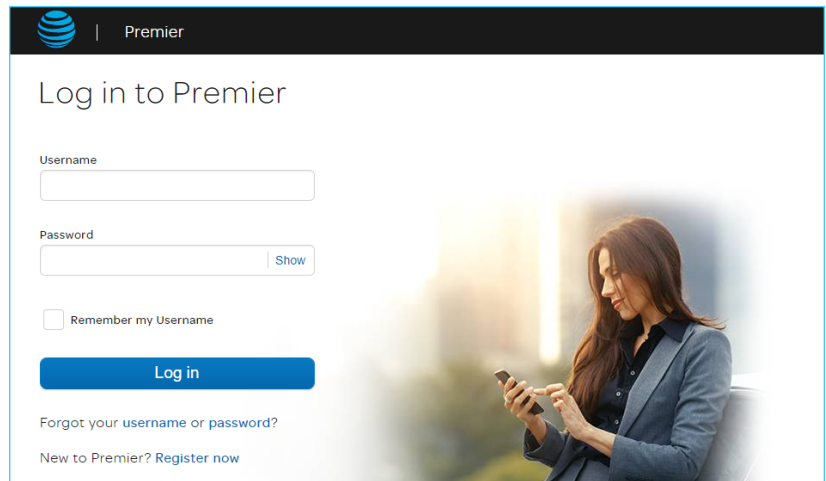

2 Select **“Bring your own device”**. Then choose to create a new account and phone number or use an existing one.

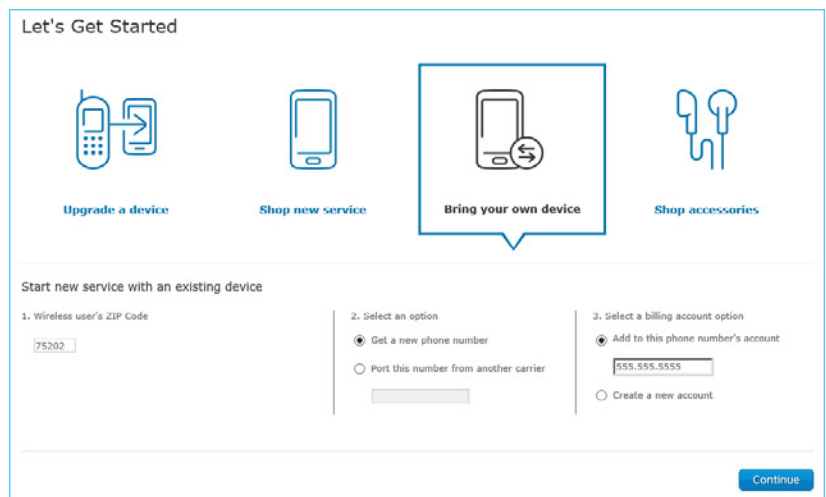

3 Enter the IMEI number from your device.

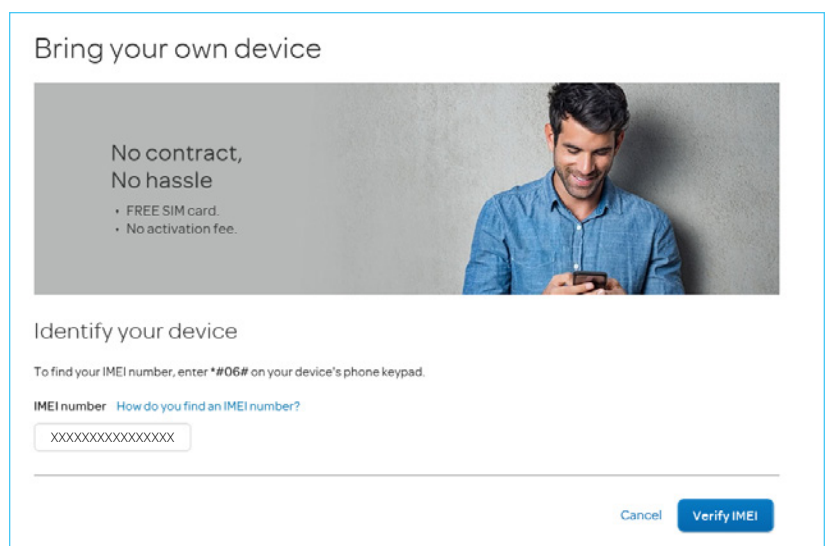
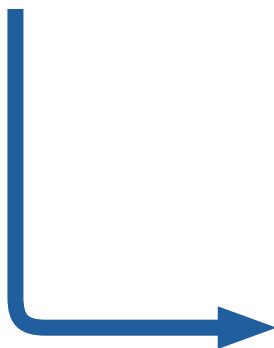

4

Enter SIM card number

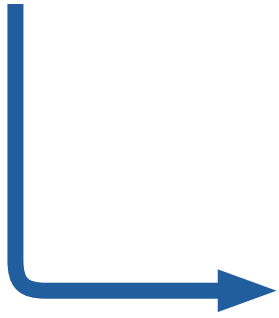

Identify your device

To find your IMEI number, enter *#06# on your device's phone keypad.

IMEI number [How do you find an IMEI number?](#)

TELIT LM960
[Select a different device](#)

How do you want to activate your service?

I have a SIM card

SIM card number [How do I find my SIM card number?](#)

I need a new SIM card (no additional charge)

[Cancel](#) [Continue](#)

5

Filter rate plans by individual plan types. Select AT&T Wireless Broadband plan: *Wireless Broadband with DTM for 4G LTE Data Devices – Up to 8/12/50**/ 100** Mbps* Backup*

*Speeds are at the modem, “up to” the stated rates, not guaranteed, subject to network availability, and the number of connected endpoints. Speeds up to 50 and 100Mbps require AT&T LTE-Advanced technologies coverage and capable device.

**Requires a wireless router with a Category 18 or higher modem and AT&T LTE-Advanced technologies network coverage.



Rate Plans

Need to join a group plan? Search existing groups. [Go](#)

Sort results by: [Recommended](#) View: [10 per page](#) Page 1 of 2 | [1,2 >>](#)

Selected Filters [Clear all](#)

Individual Plans: [0](#)

Filter By:

Plan Category

Data

Plan Type

Pooled Plans

Individual Plans

Group Plans

Features

Unlimited Data

Mobile Hotspot

Data Backup

No Rollover Data

Overage Charges

[Show more](#)

	Wireless Broadband for Private Mobile Connection with DTM for 4G LTE Data Devices - Up to 8Mbps Backup	No Voice	Unlimited Data	\$80.00 Monthly	Add to Cart
	Wireless Broadband with DTM for 4G LTE Data Devices - Up to 8Mbps Backup	No Voice	Unlimited Data	\$80.00 Monthly	Add to Cart
	Wireless Broadband for Private Mobile Connection with DTM for 4G LTE Data Devices - Up to 12Mbps Backup	No Voice	Unlimited Data	\$130.00 Monthly	Add to Cart
	Wireless Broadband with DTM for 4G LTE Data Devices - Up to 12Mbps Backup	No Voice	Unlimited Data	\$130.00 Monthly	Add to Cart

6

Review order and proceed through checkout process to place order

Shopping Cart

[Save cart](#) | [Empty cart](#) | [Add another line](#) | [Checkout](#)

Line 1 New Service: DALLAS, TX, 75202 One-time* Monthly**

Assign name	\$0.00	\$130.00
<hr/>		
Data plan Change data plan		
Wireless Broadband for Private Mobile Connection with DTM for 4G LTE Data Devices - Up to 12Mbps Bac...		\$130.00
<hr/>		
Features		
Shop for features		
<hr/>		
	One-time*	Monthly**
Grand total <small>(Additional fees are not included in the grand total.)</small>	\$0.00	\$130.00

[Add another line](#) | [Checkout](#)

© 2020 AT&T Intellectual Property. All rights reserved. AT&T, Globe logo, Mobilizing Your World, and DIRECTV are registered trademarks and service marks of AT&T Intellectual Property and/or AT&T affiliated companies. All other marks are the property of their respective owners. The information contained herein is not an offer, commitment, representation, or warranty by AT&T and is subject to change. | 16427-030320